

DESIGN | ENGINEERING | CONSTRUCTION

WATER SHAPES

Exploring the Art and Science of Water

September 1, 2022
watershapes.com

Featuring



Considering Service

All watershapes require service and maintenance. How easy or difficult the needed maintenance tasks are for the service technician is due largely to decisions made by the builder long before the pool is filled. Here Steve Kenny explains how his years of service experience, and running a service division, influence his company's approach to engineering and construction.

[CONTINUE READING](#)

**AQUA
MATIC**
COVER SYSTEMS

THE MOST DURABLE POOL
COVERS IN THE MARKET

Hydramatic | Lift Lid | HydraLux | EZ Cover



[Click Here](#)



BENEATH THE SURFACE

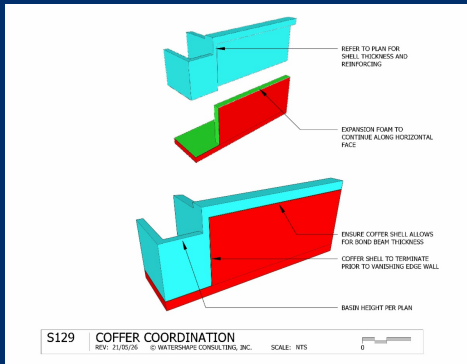

S129: Coffers Coordination

Creating containment vessels, i.e. coffers, on hillside pools often requires building the coffer far head of the pool itself. As Richard C. Kremer points out in this latest *Beneath the Surface* detail, doing so requires careful design coordination with general contractors and above all, clients.

CONTINUE READING



PIPELINE FILTERS®
SMALL FOOTPRINT,
BIG FILTRATION



AQUASTAR®
pool products
DE-LEVEL CLARITY
CLAIM BACKED BY NSF TESTING DATA



Pentair Pool Builder: Your All-in-One Platform
pentair.com/poolbuilder



Crafting Impressions

Renown tile specialist, Jimmy Reed, is passionate about his work installing breathtaking tile surfaces in swimming pools. He's also succeeded in featuring his artisanal works in a variety of media settings promoting his artistic and technical excellence. Here he offers advice and perspective for others who endeavor to elevate their reputation by way of today's accessible communications landscape.

[CONTINUE READING](#)

**VERSATILE POOL CONTROL WITH
UNMATCHED VALUE.**



HAYWARD
We Build Better.™

[Explore OmniPL™ >](#)

WOLF PACK CORNER

Wellness by Design

The Wolfpack values health and wellness, which is why Watershape University is debuting a new advanced construction course this year in Las Vegas, a unique offering that brings the world of wellness and design together with a close look at designing and

constructing these specialized facilities.



[CONTINUE READING](#)



Helps Solve Waterproofing Problems
Delamination Efflorescence Shrinkage Cracks Rebar Bleedthrough
Basecrete Works As Both the Waterproofing & Bondcoat
Spray Roll Easy Application Trowel Squeegee

WATERSHAPES WORLD BLOG

Thriving Beyond Recession

Who are the companies that thrive after times of economic hardship? The *Harvard Business Review* conducted an extensive study of that very question during the peak of the last “great” recession. As we now face a growingly uncertain economic picture, considering what they found may be of significant use today.



[CONTINUE READING](#)

DIRECT CONNECTIONS



Construction 2922: Project Profile from Design to Construction

On September 16, 2020 master pool designer Joan Roca walked through the uncommon construction methods and specific challenges encountered when designing and crafting this stunning project.

[CLICK HERE TO WATCH](#)

OPEN WATERS

Losing the Language Wars

Does the language we use to describe watershapes matter? Eric Herman thinks so, but he also admits that as a long-time industry editor, he might care a bit *too* much. Should it be “infinity edge” or “vanishing edge”? Or should “spa” be replaced with “hot tub”? Here are some colorful and loquacious thoughts on these wordy questions.

[CONTINUE READING](#)

The World's Most Trusted Pool Finishes®
pebbletec.com

Pebble Technology
INTERNATIONAL

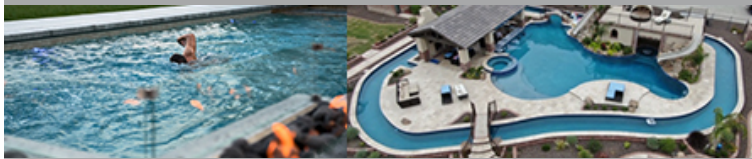

Riverflow
Smooth Powerful Current
By Current Systems, Inc.
pumps • swim in place • lazy/action river design • adventure pool • whitewater current

Print Archive

October 2000 (Vol. 2, No. 8)

As the magazine continued to expand the depth and breadth of its content, the eighth issue of WaterShapes 2000 included Jim Lampl exploring classic pond/stream design principles; Barton Rubenstein on water in kinetic sculptures; Rick Anderson on detailing streams and Rodger Embury on artificial-rock panels.

[READ IT HERE](#)



A Dynamic Systems Approach to Waterproofing

- Aqua-Blok XL
- Membrane C
- BC Pro

www.miracote.com



Aquatic Glazing International Underwater Pool Windows

Design • Engineer • Fabricate • Install



WATERSHAPES WEB CAFE



What is 'Dead Pool'?

Among the many frightening implications of the current historic drought conditions, portions of the Colorado River are so low that "dead pools" are forming, places where the river is too low to continue flowing.

What happens when rivers no longer run?

[CONTINUE READING](#)

Water is Older than the Sun

Amazing as it may seem, water on our planet, or at least some of it, is actually older than the sun. This mind-expanding article from The Space Academy explains how that's possible and the implications it holds in determining the origin of water on Earth.

Our most precious molecule has been around longer than we thought.

[CONTINUE READING](#)



CUSTOM STAINLESS & COPPER POOLS, SPAS, WATERFEATURES
SPECIALIZING IN ROOFTOP POOL & SPA INSTALLATIONS



ON TAP

Learn About the Latest Products in Market



AquaStar Debuts New Unblockable Drain

AquaStar Pool Products (Ventura, CA) has introduced the Perfect Circle drain, an unblockable drain option designed for use in concrete pools and spas. It has four ports which gives designers the ability to use multiple pumps and a hydrostatic relief valve with this one single unblockable drain cover. The open center design allows the cover to blend into the pool or spa finish.

[FOR DETAILS CLICK HERE](#)

Mistcooling Offers Pool Cooler

Mistcooling (Houston, TX) makes Pool Cooler, a simple fixtures designed decrease pool water temperatures by up to 10 degrees. The pool cooler is easy to install, made in the USA, and operates without additional electricity, an easy and cost-effective method of cooling your swimming pool compared to pool chillers, the company says.

[FOR DETAILS CLICK HERE](#)

Corporate Engagement Teammates

Watershape University appreciates the support of the following industry leaders:

A&A Manufacturing



[Trouble Viewing this email? View as a Webpage here.](#)



WaterShapes | 140 Lomas Santa Fe Dr. Ste. 202, Solana Beach, CA 92075-1252

[Unsubscribe dave@watershape.org](mailto:dave@watershape.org)

[Update Profile](#) | [Our Privacy Policy](#) | [Constant Contact Data Notice](#)

Sent byeric@watershape.orgpowered by



Try email marketing for free today!