

DESIGN | ENGINEERING | CONSTRUCTION

WATER SHAPES

Exploring the Art and Science of Water

May 6, 2021
watershapes.com

Featuring



Luxury in Blue

One of the biggest and most common mistakes watershapers can make, cautions builder Dave Penton, is projecting their own financial perspectives onto their clients. It's a misstep that can, he says, lead to an errant assumption the customer is either unable or unwilling to pay for something that might seem extremely expensive to most others.

[CONTINUE READING](#)

**AQUA
MATIC**
COVER SYSTEMS

THE MOST DURABLE POOL
COVERS IN THE MARKET
Hydramatic | Lift Lid | HydraLux | EZ Cover



[Click Here](#)



The Big Cover Story

Deploying its slat-based automatic cover, Aquamatic Cover Systems recently completed work on a massive existing pool on a college campus where administrators were looking for a state-of-the-art way to conserve both water and energy, all with the touch of a button.

[CONTINUE READING](#)

TWINSCAPE

REINVENT THE ART OF SPACE

In just eight minutes...



BENEATH THE SURFACE

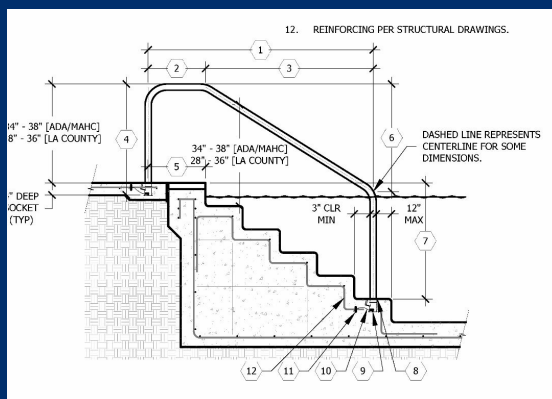

Detail: A151

Commercial pools must conform to a variety of safety and operational requirements, beyond those found in the residential segment of the industry. The ubiquitous 3-bend handrail is no exception. As Dave Peterson explains, even this simple design sometimes fails in implementation -- but help is on the way with this nifty and useful detail.

[CONTINUE READING](#)

WATERSHAPES WORLD BLOG

Views on Views

Regardless of style, scale or budget, watershape design in one way or another is about forging connections with the surroundings, especially in the presence of natural beauty. Making those natural connections by way of orchestrating human experience is a philosophy that has driven some of history's greatest designers and continues to resonate today.



[CONTINUE READING](#)

**VERSATILE POOL CONTROL WITH
UNMATCHED VALUE.**



HAYWARD
We Build Better.™

[Explore OmniPL™ »](#)

DIRECT CONNECTIONS



Riding a River

Lazy Rivers are among the most complex systems found in residential settings. In this installment of Direct Connections, builder Scott Payne details a recent backyard river project that pushed him and his company beyond their comfort zone, but one that yielded a treasure trove of knowledge and a river that takes the clients for a joy ride.

[CONTINUE READING](#)

OPEN WATERS

A Million Blue Marbles

As part of Wallace "J" Nichols Year of Blue Mind, he recently offered a reading from his seminal book of the same name. Here is Chapter 9: A Million Blue Marbles, a treatise that broadens perspectives by focusing on something simple and small.

[CONTINUE READING](#)

WOLF PACK CORNER



A Construction Tour de Force

Watershape University proudly introduces its most comprehensive online educational offering to date – CON 2211: Essential Pool Construction Workshop. It's all about understanding essential construction processes needed to competently construct swimming pools, and other concrete structures that contain decorative and/or recreational water.

[CONTINUE READING](#)

Print Edition

April 1999, (Vol. 1, No. 2)

WaterShapes' second print issue included Roger Hopkins on creativity with stone; Michael Nantz on signature watershapes; Fred Hare on hydraulic design; Curt Straub on shell curing; David Tisherman on shaping a great pool.

[CONTINUE READING](#)

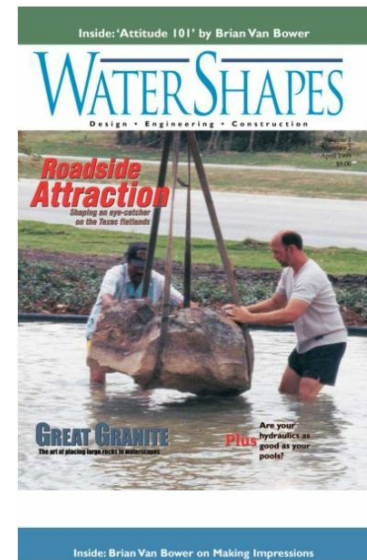

THE WATERSHAPES WEB CAFE

We Browse So You Don't Have To!



Heroic Dog Saves Best Friend from Drowning

Jessie, a 7-year-old Staffordshire bull terrier, saved Chucky, an aging Pomeranian from drowning in the backyard pool – all caught on a security camera.

[CONTINUE READING](#)

Microbots Combat Surface Water Pollution

Scientists from Nuremberg and Düsseldorf have figured out a way to clean oil spills from surface water, among other things using tiny rotating robots.

[CONTINUE READING](#)

ON TAP

Learn About the Latest Products in Market



Forever Bamboo Makes Tikki Huts

Forever Bamboo (San Diego, Calif.) manufacturers traditional bamboo Tikki huts and palapas. Made using traditional material, including bamboo posts and thatched roofs, the huts are also fire and insect retardant with material that is all sustainably resourced. They come ready to assemble in standard sizes and can also be custom made.

[CONTINUE READING](#)

Desert Steel Creates Palm Trees

Desert Steel (Wichita, Kan.) manufacturers a line of steel palm trees for creative landscape designs. The trees come in a variety of sizes are made of all-weather steel construction, and are color-fast and corrosion resistant. They require concrete mounting pads measuring 30-by-30 inches by 10-inches thick.

[CONTINUE READING](#)

Corporate Engagement Teammates

Watershape University appreciates the support of the following industry leaders:



[Trouble Viewing this email? View as a Webpage here.](#)

